

CHILTON[®]LIBRARY

Your Current Vehicle: 2011 Honda Fit

Rate this article: ★ ★ ★ ★ ★

Front Damper/Spring Removal and Installation

NOTE

Applicable vehicles:

- 2009-13 Honda FIT

Front Damper/Spring Removal and Installation

Removal

1. Raise and support the vehicle.
2. Remove the front wheel.
3. Remove the wheel speed sensor (A) from the knuckle. Do not disconnect the wheel speed sensor connector.

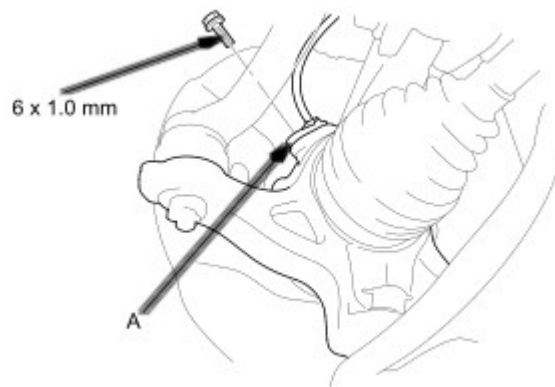

4. Disconnect the stabilizer link from the damper.
5. Remove the wheel speed sensor clip (A), the wire

guide grommet (B), and the brake hose bracket (C) from the damper. Do not disconnect the wheel speed sensor connector.

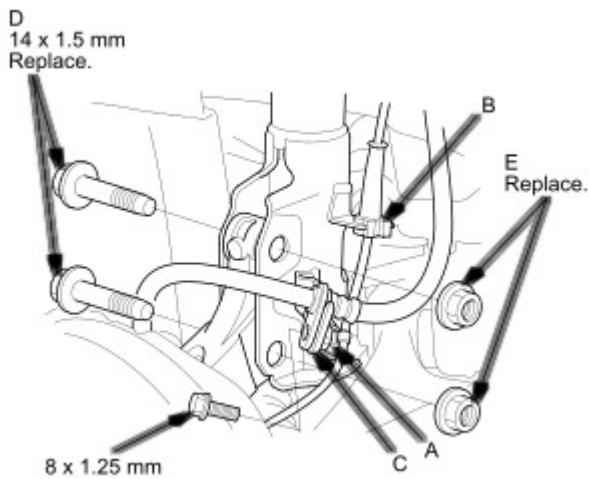

6. Remove the damper pinch bolts (D) and the self-locking nuts (E) from the damper.

NOTE: Do not allow the knuckle to rotate too far outward. This may allow the driveshaft inboard joint to come apart.

7. Passenger's side removal: Remove the lid (A).

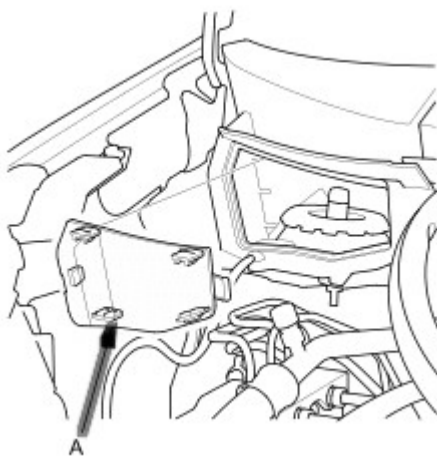

8. Driver's side removal: Remove these items:

- Wiper arms
- Cowl cover
- Wiper motor

9. Remove the damper cap (A) from the top of the damper.

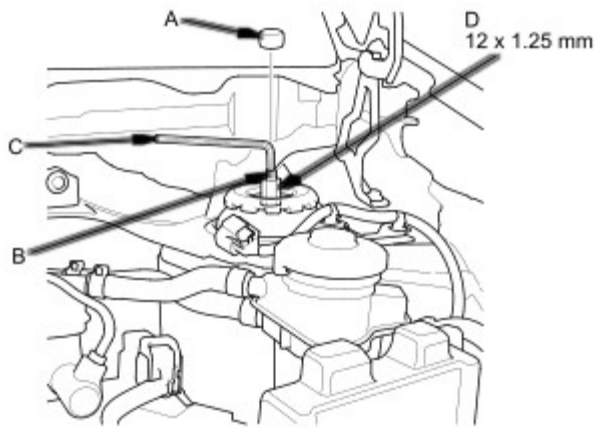

10. Hold the damper shaft (B) using a hex wrench (C), and loosen the damper mounting nut (D).
11. Remove the damper mounting nut (A) and the wave washer (B), then remove the damper mounting base (C) from the top of the damper.

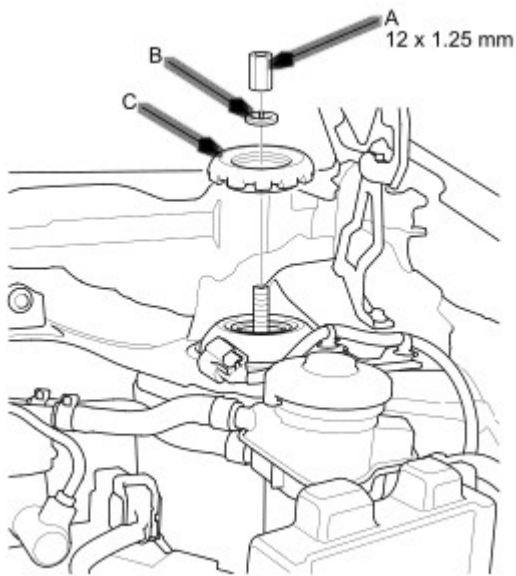

12. Remove the damper/spring (A) and the damper rubber mount (B).

NOTE: Be careful not to damage the body.

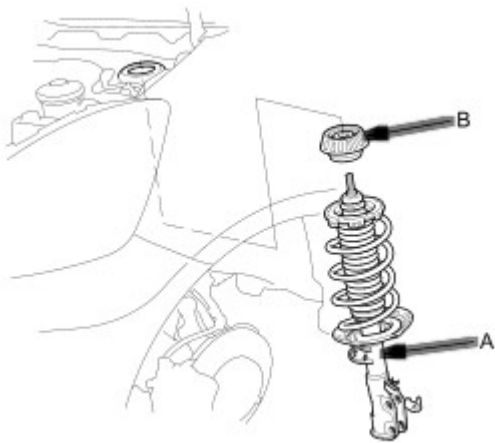

Installation

1. Install the damper rubber mount (A) and the damper/spring (B) onto the upper mount.

NOTE: Be careful not to damage the body.

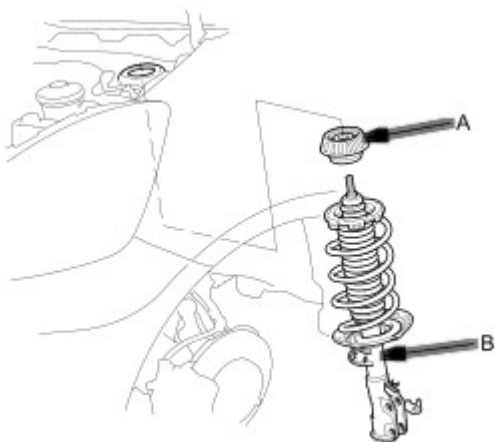

2. Install the damper mounting base (A) and the wave washer (B), then loosely install the damper mounting nut (C).

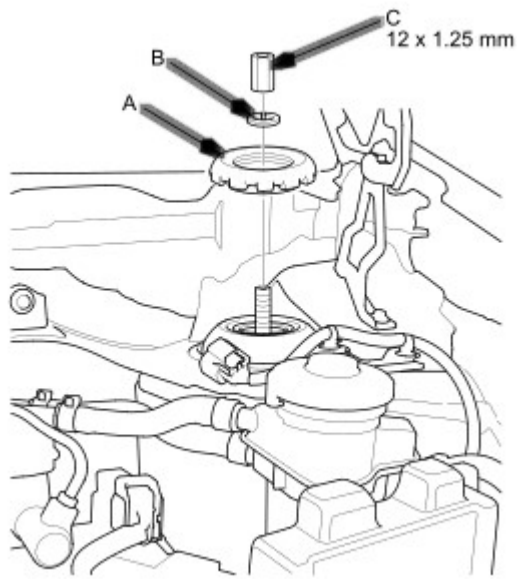

3. Loosely install new damper pinch bolts (A) and new self-locking nuts (B).

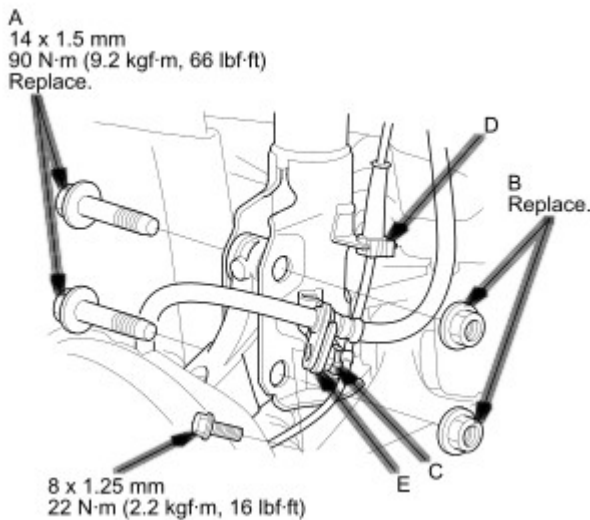

4. Install the wheel speed sensor harness clip (C), the wire guide grommet (D) and the brake hose bracket (E) to the damper.
5. Place a floor jack under the lower arm, and raise the suspension to load it with the vehicle's weight.
6. Tighten the damper pinch bolts while holding the self-locking nuts to the specified torque.
7. Connect the stabilizer link to the damper and tighten to the specified torque.

8. Hold the damper shaft (A) with a hex wrench (B), and tighten the damper mounting nut (C) to the specified torque.

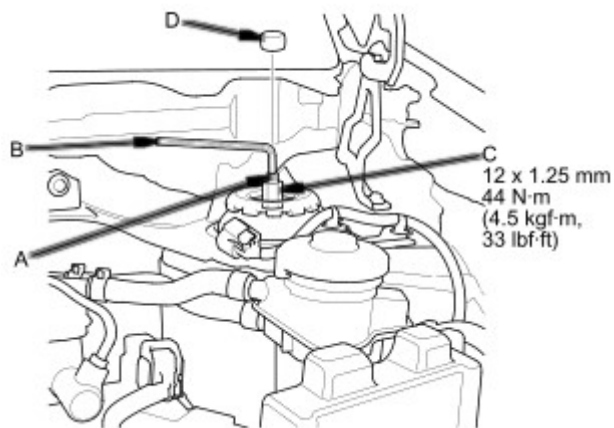

9. Install the cap (D) to the top of the damper.
10. Driver's side installation: Install these items:

- Wiper motor
- Cowl cover
- Wiper arms

11. Passenger's side installation: Install the lid (A).

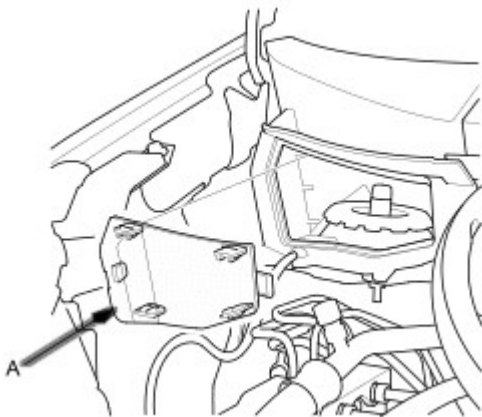

12. Install the wheel speed sensor (A) to the knuckle.

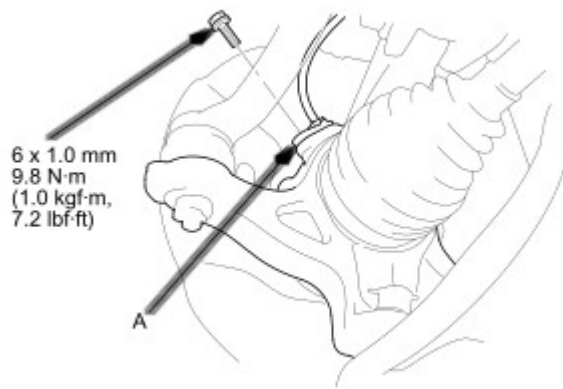

13. Clean the mating surfaces between the brake disc and the inside of the wheel, then install the front wheel.
14. Check the wheel alignment, and adjust it if necessary.

Copyright ©2019 by Chilton, an imprint of Cengage Learning

(//lh/Home/Index/mwell1QKVTwb7-pjj4lEwfrPKgWUdhY0fwXVo7m_KxVWOv1w1)Home

Terms and Conditions (//www.cengage.com/content/footer/terms_of_use.aspx)

Privacy Statement (//www.cengage.com/content/footer/privacy_statement.aspx)

Contact Us (//www.cengage.com/contact/)

